

STUNNING PLUG & PLAY FULLY FITTED

GRADE 'A' OFFICE FLOOR TO LET

THE MET BUILDING, 22 PERCY STREET LONDON W1

4,527 SQ FT



LOCATION This landmark office building which was recently the subject of a major refurbishment by Lazari, is situated in the heart of Fitzrovia at the junction of Percy Street with Tottenham Court Road. Tottenham Court Road and Goodge Street underground stations are within a few minutes walk.

SPACE Comprises the entire 8th floor with stunning views Over central London totalling approximately 4,527 sq ft recently fitted and furnished and hardly used by our client to provide a reception, 2 large meeting rooms, 1 smaller meeting room, 7 private offices, 2 open plan areas, comms room and kitchen/breakout area.

The offices are ready to walk into without further expense.

AMENITIES

- IMPRESSIVE GROUND FLOOR RECEPTION
- END OF TRIP FACILITIES
- PLASTERED CEILING
- LED LIGHTING
- NEW AIR CONDITIONING
- COMMISSIONAIRES
- MET LOUNGE AVAILABLE FOR ALL TENANTS USE
- FIBRE OPTIC CABLING
- FULLY FURNISHED
- TERRIFIC NATURAL LIGHT
- STUNNING VIEWS ACROSS LONDON
- OWN W.C's

TERMS

LEASE A short term lease is available for a term up to 3 years.

RENT £734,000 per annum inclusive of rates and service charge.



Reception



Open Plan Area



Meeting Room 1



Meeting Room 2



Kitchen/Breakout



Kitchen/Breakout



Open Plan Area



Typical Office



The Met Lounge

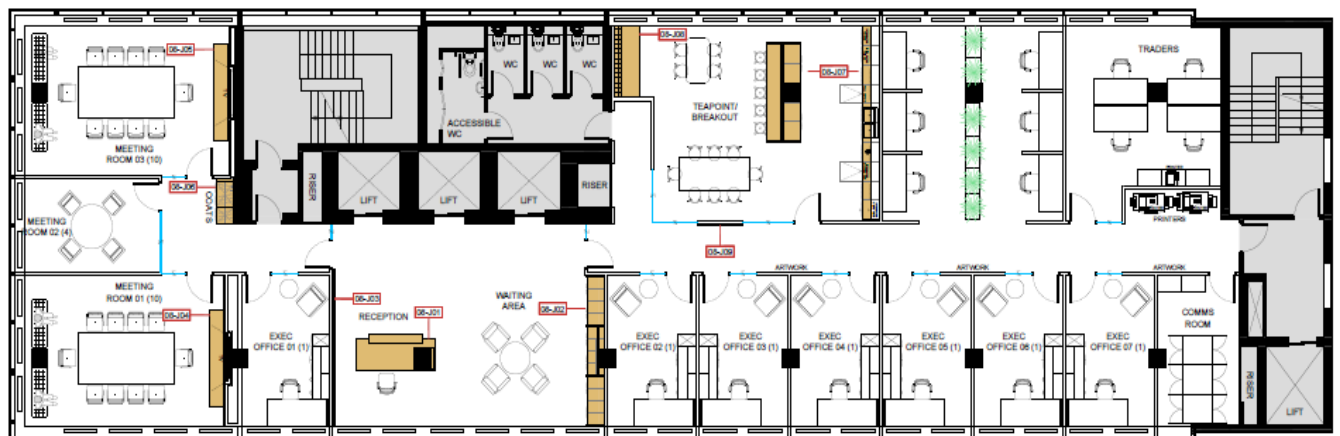

Floor Plan